



WINSFEED

GOLDTWIN

7XD HOLDER FOR DEEP HOLE DRILLING

7XD HOLDER FOR DEEP HOLE DRILLING WITH IMPROVED MODULAR HEAD COOLANT SYSTEM

- One drilling head covers various drilling depths: 3xD, 5xD, 7xD •
- 7xD drill diameter range: 26-41 mm •
- Through-coolant hole system •
- Improved machining stability •
- Increased tool life •

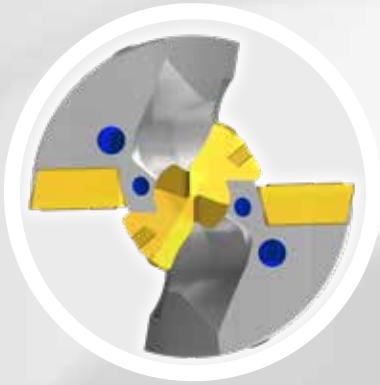

3xD

5xD

7xD
New

GOLDTWIN 7XD DRILL HOLDER

General Information

The **GoldTwin** family now includes a 7XD holder for better stability in deep hole drilling.





GoldTwin product line has been expanded with a new 7xD holder that allows for deeper hole machining with excellent machinability, hole quality and tool cost savings. End-users now have the option to drill various depths, such as 3xD, 5xD and 7xD, with one head.

In addition, a coolant flow channel aimed at the cutting edge has been added to the modular head to achieve higher stability machining and improved chip evacuation.

** The **GoldTwin** head with the new through-coolant system will keep the current product number designation and become available after the existing stock is exhausted.*

Technical Features & Advantages

- One drilling head covers various drilling depths: 3xD, 5xD, 7xD
- 7xD drill diameter range: 26-41 mm
- Improved machining stability and tool life with through-coolant hole system

Head	Holder	
	3xD	 <p>Drilling depth: 3xD</p>
	5xD	 <p>Drilling depth: 5xD</p>
	 7xD	 <p>Drilling depth: 7xD</p>

New Coolant Supply

Additional coolant flow channel aimed at the cutting edge

- Improved machining stability and tool life due to smooth chip evacuation

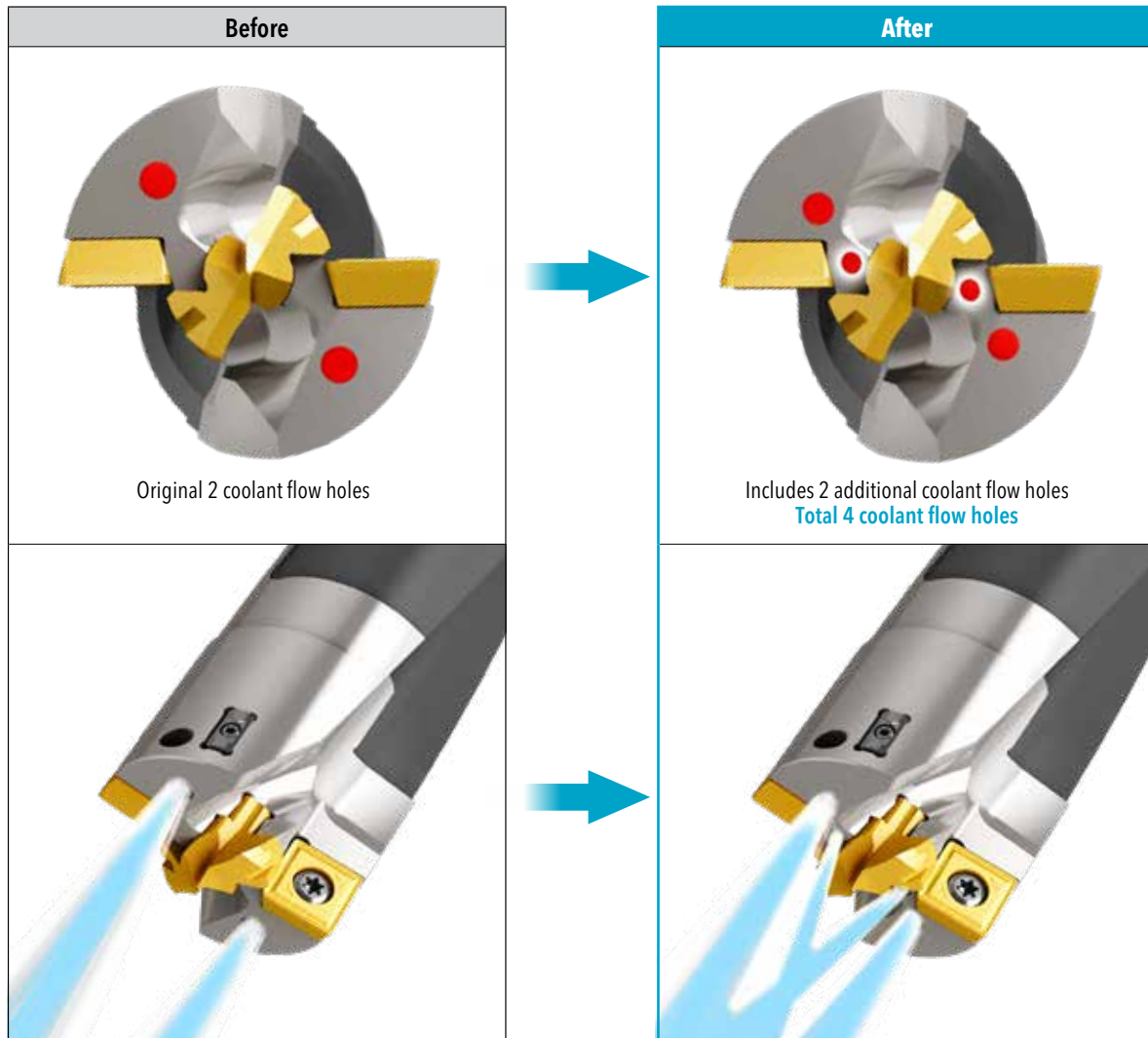

GOLDTWIN MODULAR DRILL BASIC HOLDER 7D

ADAPTION ACC. TO DIN 1835 B

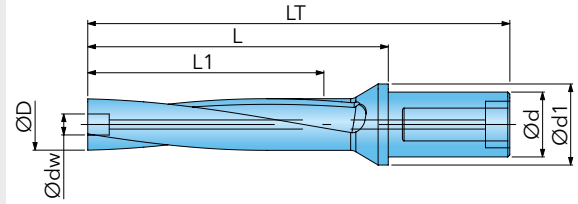

Designation	D min.	D max.	d	dw	d1	LT	L	L1	Bs		
W032YFSA168	26	27	32	10,4	40	262,3	202,3	168	CD26_/27_	✓	0,95
W032YGSA180	28	29	32	11,2	40	276,5	216,5	180	CD28_/29_	✓	1,10
W032YHSA193	30	31	32	12,0	40	289,5	229,5	193	CD30_/31_	✓	1,23
W032YJSA205	32	33	32	12,8	40	303,7	243,7	205	CD32_/33_	✓	1,30
W040YKSA218	34	35	40	13,6	50	328,2	260,2	218	CD34_/35_	✓	1,70
W040YLSA230	36	37	40	14,4	50	342,5	274,5	230	CD36_/37_	✓	1,85
W040YMSA242	38	39	40	15,2	50	355,4	287,4	242	CD38_/39_	✓	2,00
W040YNSA255	40	41	40	16,0	50	369,6	301,6	255	CD40_/41_	✓	2,17

SPARE PARTS

①



②



Diameter Range

26 - 27	BLD H-W2.5X280	SW6-TSH
28 - 35	BLD H-W2.5X380	SW6-TSH
36 - 41	BLD H-W3.0X430	SW6-TSH

① = Torx-bit BLD ② = handle

Ingersoll Werkzeuge GmbH

Main Office:

Kalteiche-Ring 21-25 • D-35708 Haiger
Tel.: +49 2773 742-0 • E-mail: info@ingersoll-imc.de

Office South:

Florianstraße 13-17 • D-71665 Vaihingen-Horrheim
Tel.: +49 7042 8316-0 • E-mail: horrheim@ingersoll-imc.de

www.ingersoll-imc.de